

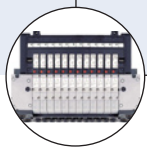

3/2, 5/2 and 5/3-way Pneumatic slave valves

- High flow rate 1300 l/min
- Long service life, even in non-lube conditions
- Corrosion resistant, ideal for demanding conditions
- Multifunctional, modular design

Type 0475 can be combined with...



Type 8640

Valve bank



Type 2671

Quarter turn valve



Type 2000

Angle seat valve

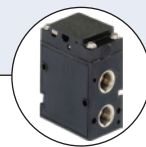

Type 0475

3/2 way version

The Type 0475 is a servo-assisted spool valve. The standard version is suitable for stand alone operation or combined to a manifold, while the Namur version is designed for direct field-mount to pneumatic actuators.

Materials used in production of the 0475 valve make it highly resistant to difficult, dirty or corrosive environments.

Technical data

Orifice	Standard Namur	DN 8.0 and 9.0mm DN 6.0mm
Body material	Standard Namur	Polyamide (PA), reinforced Polyamide (PA)
Thread insert material		Brass, stainless steel
Seal material		NBR, NBR & PUR
Media		Compressed air, neutral gases
Media temperature		-10 .. +50°C
Ambient temperature		-25 .. +55°C
Port connection (standard)	Supply, service	Threaded port G1/4" (NPT on request)
Port connection (Namur)	Supply connections 1, 3, 5 Service port 2 & 4	Threaded port G1/4" (NPT on request) Namur flange
Signal Port		M5

Applications

- Process systems
- Food & beverage industry
- Mineral processing
- Demanding environments

External pilot pressure chart



NB: Vacuum only for 3/2 NC VAC valve, on request

www.burkert.com.au

Ordering chart for valves (other versions on request)

Standard version

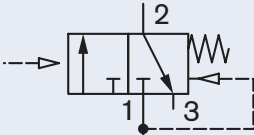
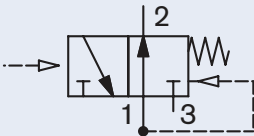
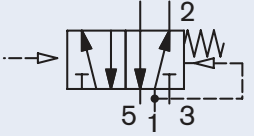
Circuit Function	Port connection threaded port	Orifice [mm]	Q _{Nn} value air [l/min]	Pressure range [bar]	Brass ID No.	Stainless Steel ID No.
C 3/2-way NC 	G1/4"	8.0	1300	2 .. 8	125 611	Avail on detailed spec
D 3/2-way NO 	G1/4"	8.0	1300	2 .. 8	125 613	Avail on detailed spec
H 5/2-way monostable 	G1/4"	8.0	1300	2 .. 8	125 616	Avail on detailed spec

Namur version

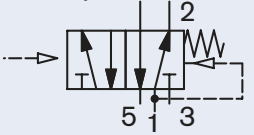
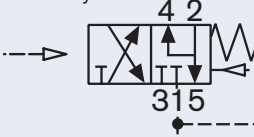
Circuit Function	Port connection threaded port	Orifice [mm]	Q _{Nn} value air [l/min]	Pressure range [bar]	With Brass Inserts ID No.	With SS316L Inserts ID No.
H 5/2-way  or C 3/2-way NC 	G1/4"	6.0	1300	2 .. 8	423 394	423 397

i Further versions on request

- Approvals**
 EEx, IECEx hazardous location approvals
 UL, UR, CSA
 EC Gas Appliance Directive
 SIL

i Valves are supplied in the 5/2 way function.
 The 3/2 way function may be set by replacing the enclosed adapter plate.

Dimensions [mm] Standard 3/2 Way Version, C and D Circuit Function

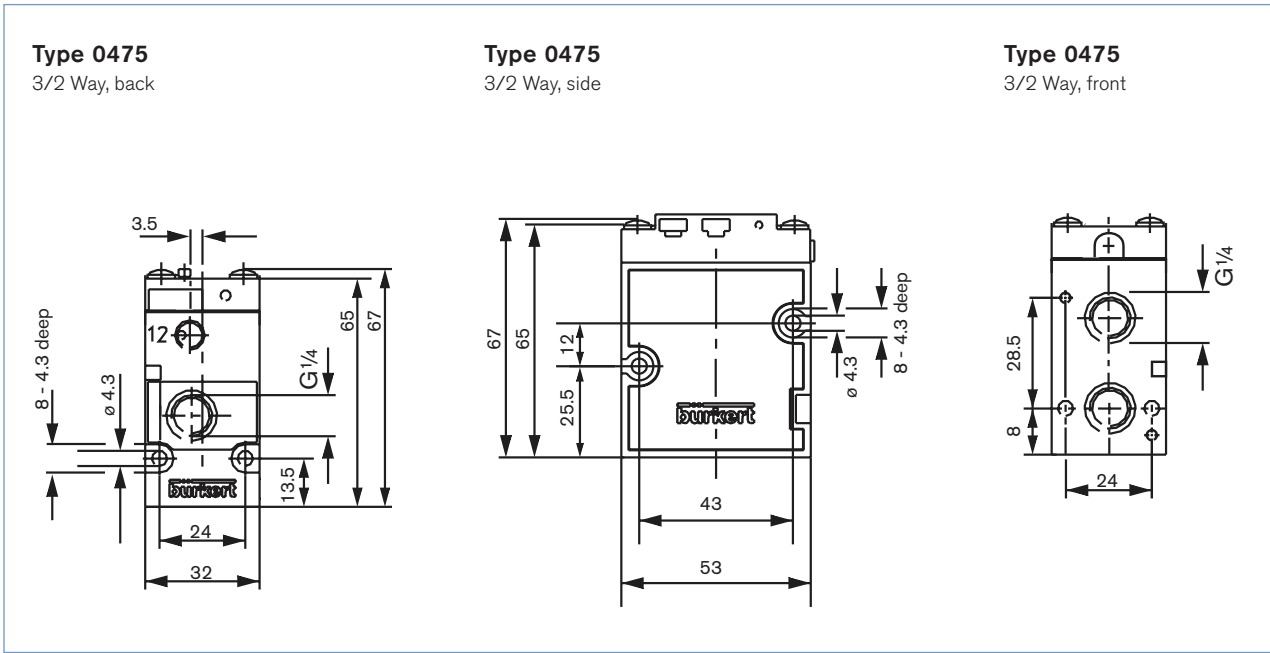

Dimensions [mm] Standard 5/2 Way Version, H Circuit Function

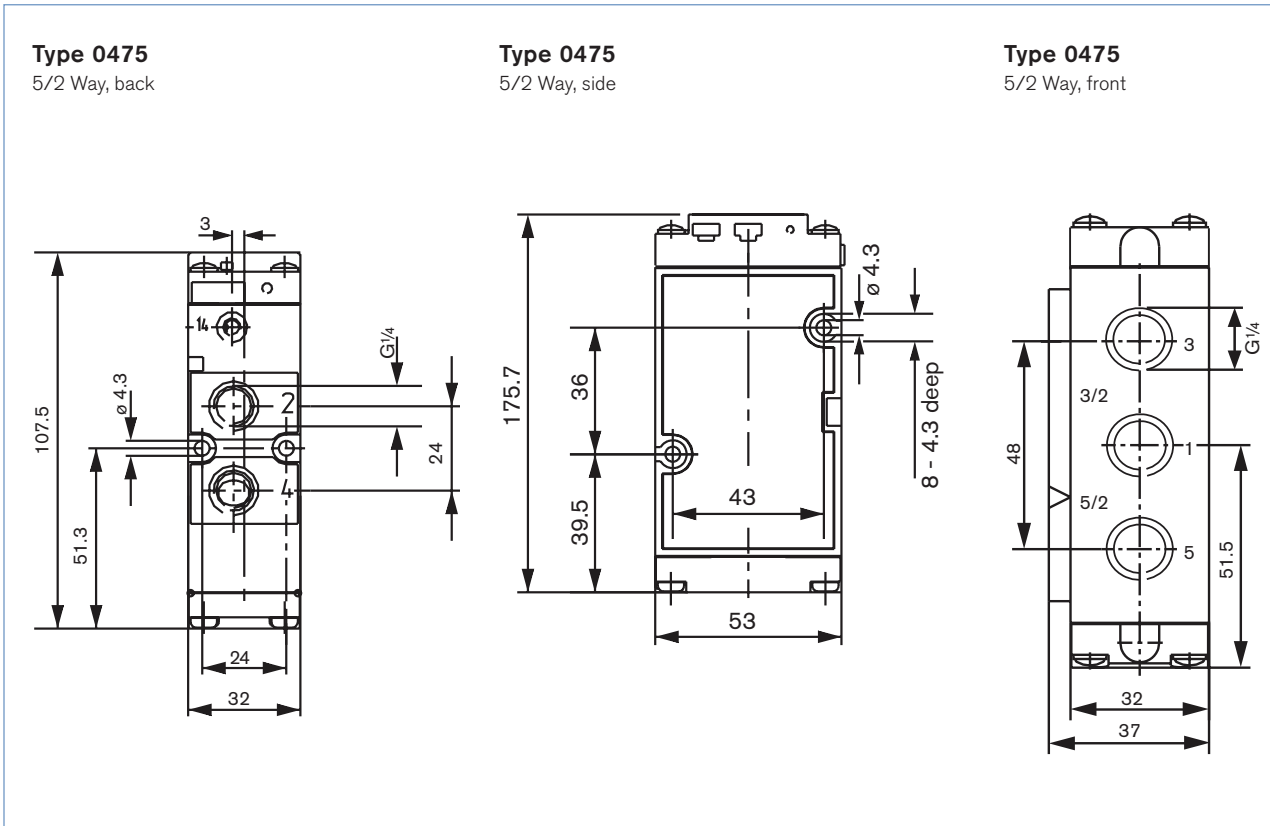

Dimensions [mm] Namur Version

Type 0475

Front view

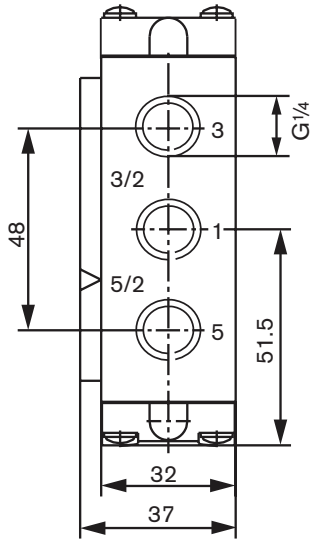

Type 0475

Side view

